

Thank you for your purchase of Giabo Egg Daily. Please read these instructions carefully before operating the appliance.

### Warning

- Keep out of reach of children. Do not allow children to use the appliance without supervision.
- Keep your appliance away from heat sources, direct sunlight or open flames.
- Do not use this product if it has a damaged power or plug, or not working properly. Do not try to self-repair, as this will invalidate your warranty.
- If the appliance has malfunctioned or has been damaged, please return it to our customer service centre for examination.
- Always unplug the power source when not in use.
- This appliance is not intended for use by persons (including children) with reduced physical, sensory or mental capabilities, or lack of experience and knowledge, unless they have been given supervision or instruction concerning use of the appliance by a person responsible for their safety.
- This appliance is designed for household use. Do not use outdoors or for commercial and/or industrial purposes.
- Never use the appliance with damp or wet hands.

### Safety Instructions

- Never leave unattended during operation.
- Do not touch the hot surface of the appliance during operation to avoid scald.
- To avoid electric shock, do not put the main body and the power cord into any liquid such as water, detergents.
- Do not place the cooking tube in the dish-washing machine to prevent from malfunction.
- Unplug the appliance when not in use. Please use neutral detergent with water to clean the cooking tube after the tube cool down completely. It is reminded that barbed wire or scaling brush should not be used for cleaning to avoid scratching away the protective material on the surface of the cooking tube.
- Not recommend to use the same wall outlet with any other electrical appliances to avoid overloading.
- Always use the appliance on a stable, flat, clean and dry surface.
- Unplug the appliance when not in use or before cleaning.
- Do not let the cord hang over the edge of a table or doorsill. Do not put the cord near any hot surface such as stoves and heaters.

-7-

### Preparation

Use the attached sponge brush to clean the cooking tubes thoroughly, then press the key "ON" to pre-heat for 3-4 minutes. (Do not put any ingredients into the tubes for the first time of usage). When the power on indicator changes from Orange to Green, the unit is ready for use.

#### A. Two Eggs

When the light changes from Orange to Green, the unit is ready for use. Spray little oil into the inner wall of the tube evenly and you can start cooking.

- Put two eggs into each tube separately and insert the skewer.
- The Orange indicator will lit again when the appliance re-heats. The egg roll will rise from the tube gradually after 9-12 minutes.
- Use skewer or chopsticks to take the cooked egg roll out. Note: As taste preference varies, if you find the upper part of the egg roll has not been fully cooked, please take them out and turn around for further cooking.

#### B. A Whole Egg + Ingredients

After spraying oil, crack and pour an egg into the tube and then put in other ingredients (fill up to approximately 60% will be fine); insert a skewer. During cooking, it is normal to notice slight smoke and cooking sound. After cooking for 9-12 minutes, the food will rise up gradually.

Note 1: you can try different ingredients to mix and match your creative recipes;

Note 2: always pre-cook the meat before putting into the tube;

#### C. Other Ingredients

Giabo Egg Daily offers users to cook other recipes other than egg. But it is recommended that users start this operation only after gaining enough experience and technique;

Note 1: Users need to take the food rolls manually, as they will not rise up automatically.

Note 2: Always wear insulate gloves when taking out the cooking tubes; and keep out of reach of children to avoid accidents as the tubes are still in very high temperature.

Note 3: After taking out the food, always remember to put back the tubes into the device immediately. Do not leave them on the table since the tubes are still in very high temperature.

Note 4: It is recommended to cook the rolls on both sides to let them cooked evenly.

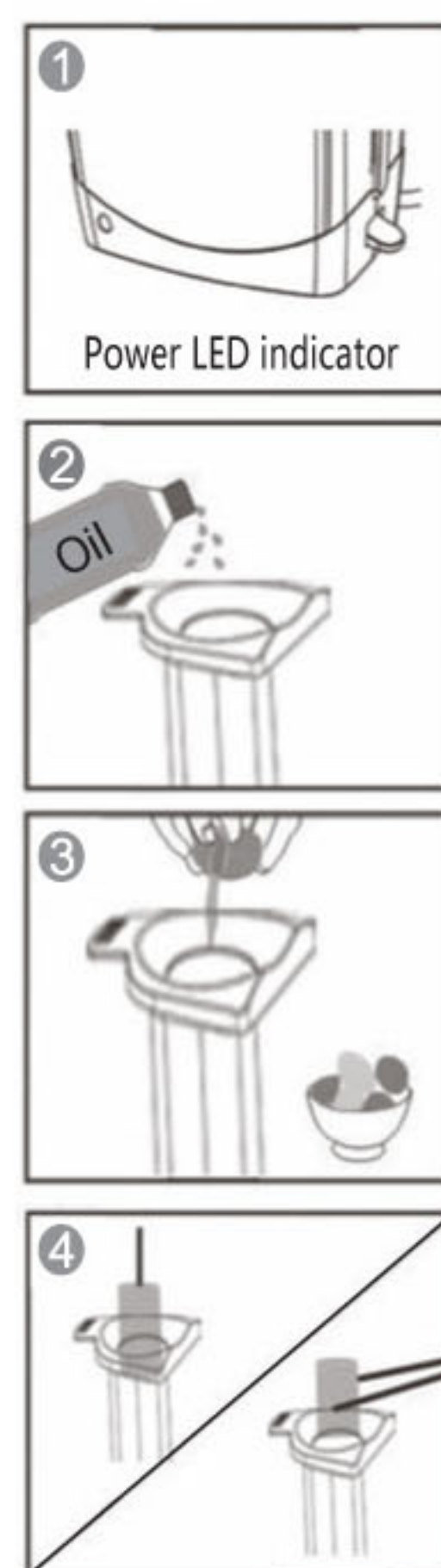

-8-

### PART NAME

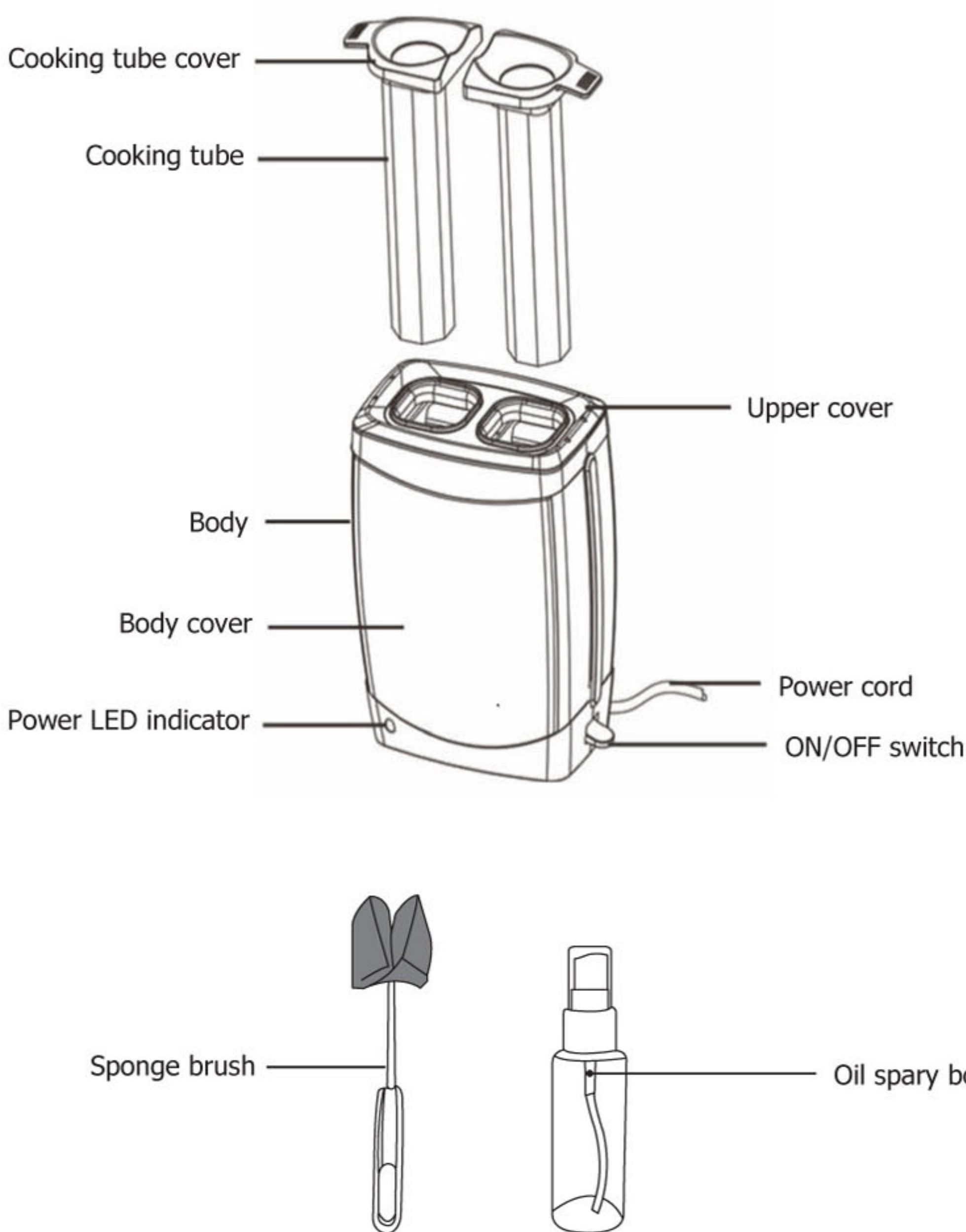

-9-

### LED Indicator

Orange LED On	Pre heating mode
Green LED On	Ready to cook
Orange and Green LED are flashing alternately	Re-heat again

### Reminder for usage

- If egg rolls do not rise up from the tubes, please see the below:

Normal usage	If egg rolls do not rise up from the tubes after 12 minutes	How to solve
Two eggs/ Beat Egg	Due to insufficient oil on the inner wall of the tubes.	Simply use a skewer or chopsticks to separate the egg from the inner wall and take it out.
A whole egg + Ingredients	Due to insufficient oil on the inner wall of the tubes; Too much ingredients being added; Some chips of egg adhere on the inner wall.	
Other ingredients (i.e. bread or meat)	Nil	Please take the food out manually.

### Cleaning Tips

- If there is any food scraps stuck on the inner wall of the tube, use a skewer or chopsticks to remove them or soak it in warm water for further washing. Do not beat the tube to avoid any damage. If the cooking tubes are broken due to improper treatment or cleaning, they are out of the service warranty scope and customers need to purchase from retailers or the sole agent.
- Switch off the appliance and disconnect from supply before cleaning.
- A damp cloth should be used to clean the body or the outside of the tube.

-10-

### Q&As

#### Common Q&As

Q:The upper part of egg roll has not been fully cooked.	A: Too much ingredients; not being heated evenly. Please take it out & turn around for further cooking.
Q:Egg rolls do not rise up automatically.	A: Please refer to "Reminder for usage" Table 1.
Q:Egg/ food scraps stick to the inner wall and hard to be removed.	A: It will affect next cooking performance. Remove the tubes and immerse them in warm water with detergents for awhile then use the sponge brush to clean them thoroughly.

### Product Specification

Model No.	GEM-01
Voltage	220-240V~
Rate Frequency	50Hz
Rate Power	350W
Capacity	4 pcs / Eggs
Weight	1.1KG
Size	L150XW100XH218(mm)

	Giabo Egg Daily	Shop Chop
Model No.	<b>GEM-01</b>	
Serial No.		
Customer Name		
Purchase Date		

-11-

### Limited Warranty

Thank you for your purchase. We hope you enjoy your Giabo Egg Daily.

- Please keep the original invoice for maintenance service.
- If the appliance malfunctions or has been damaged in any manner, do not try to repair it. Return the appliance to our customer service centre for inspection or repair.
- If the cooking tubes are broken due to improper treatment or cleaning, they are out of the service warranty scope and customers need to purchase from retailers or the sole agent.
- This warranty is valid for 12 months from the date of purchase. During the validity of this warranty, our customer will be entitled to free maintenance service. However, this warranty does not cover the following conditions:
  - All damages caused by accident, negligence, abuse, misuse, improper voltage, normal wear-and-tear or any unauthorized repair or being tampered;
  - Commercial or industrial use. Or use for other than intended use;
  - Use of unauthorized parts and / or replacement parts not under warranty. Such repair will be charged at cost;
  - No valid sales invoice is presented. The invoice should have the following information printed: name of dealer, model number and purchase date;
- This warranty is valid in Hong Kong Special Administrator Region only.

Chiap Hua International Limited  
 Customer Service HotLine: (852) 2370 0121  
 Address: 4/F, 2 Dai Wang St, Tai Po Industrial, Tai Po, N.T. Hong Kong  
 E-Mail: service.giabo@chiaphua.com.hk  
 Website: www.Giabo.com

-12-